

DEEBOT OZMO 610

Quick Start Guide



Read safety instructions before use.

Follow the below instructions strictly.

For complete instructions, please refer to the Instruction Manual. Or, visit global.ecovacs.com/instructions to download the Instruction Manual in more languages.

For more questions, please contact: ☎ 1-844-ECOVACS (326-8227) ✉ customerservice@ecovacsrobotics.com

Antes de utilizar, lea las instrucciones de seguridad.

Siga rigurosamente las instrucciones a continuación.

Pour obtenir des instructions complètes, consultez le Manuel d'instructions, ou visitez le global.ecovacs.com/instructions pour télécharger le Manuel d'instructions dans davantage de langues.

Si vous avez d'autres questions, veuillez communiquer avec : ☎ 1-844-ECOVACS (326-8227) ✉ customerservice@ecovacsrobotics.com

Lire les consignes de sécurité avant l'utilisation.

Suivez rigoureusement les instructions ci-dessous.

Para ver las instrucciones completas, consulte el manual de instrucciones, o visite global.ecovacs.com/instructions para descargar el manual de instrucciones en más idiomas.

Si tiene preguntas adicionales, comuníquese con: ☎ 1-844-ECOVACS (326-8227) ✉ customerservice@ecovacsrobotics.com

1

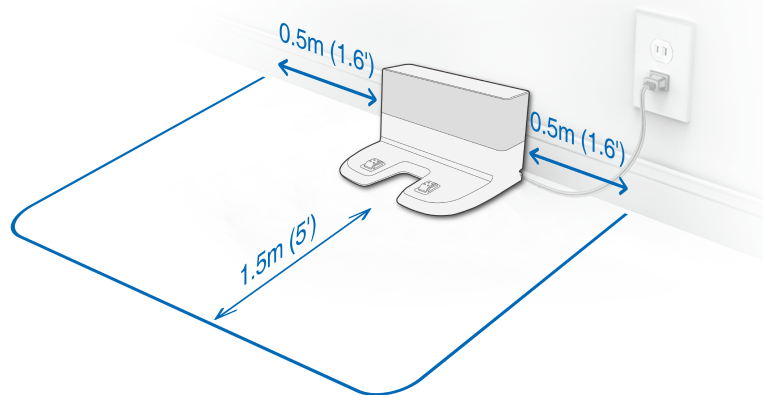

2

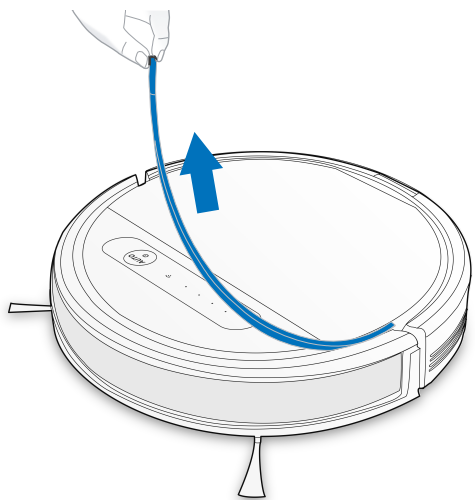

3

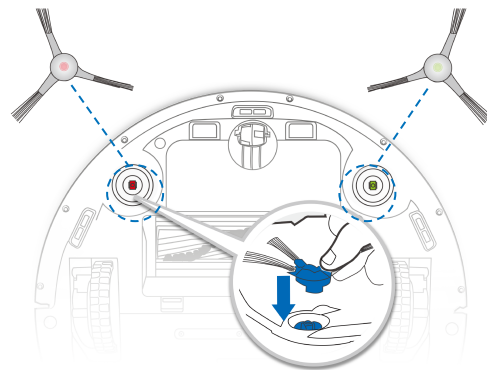

4

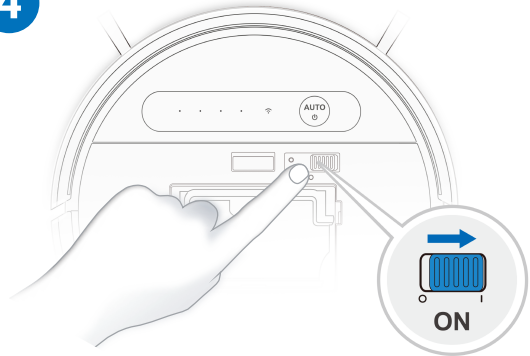

5

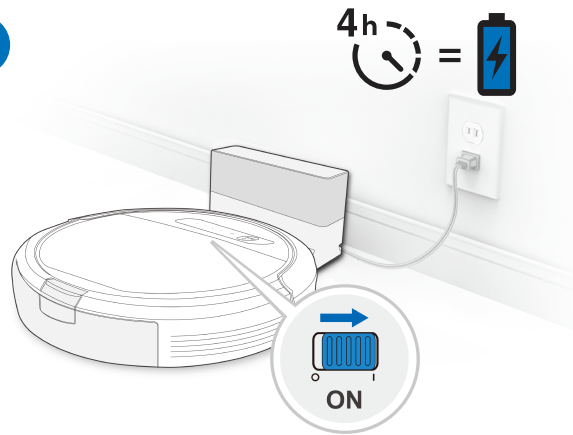

6

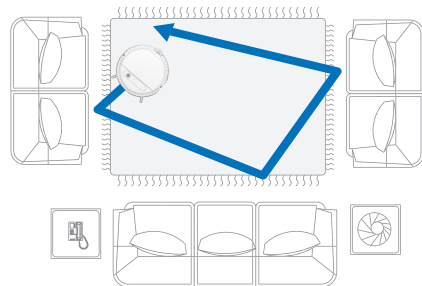
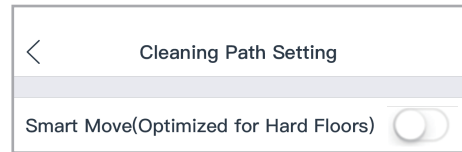
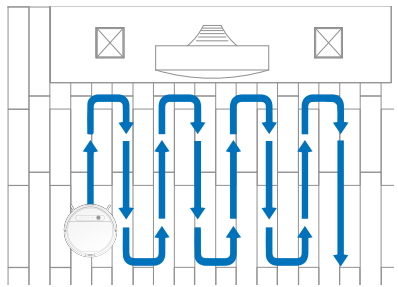
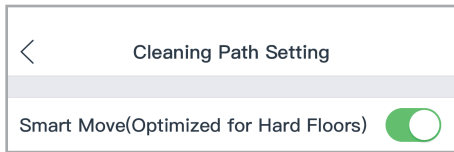

OR

OZMO™ Mopping System

1

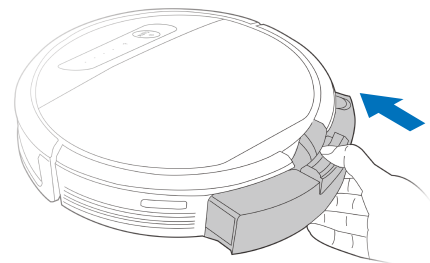
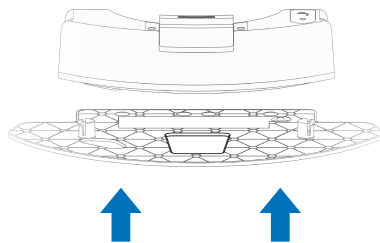
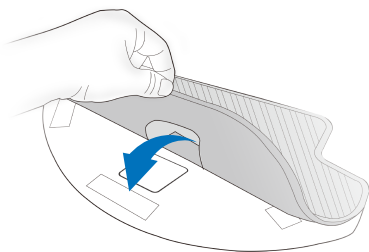
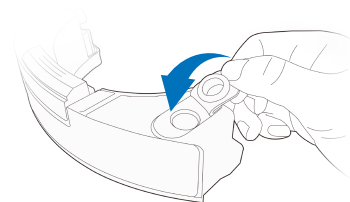
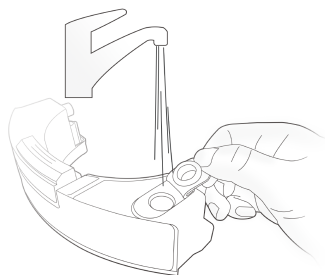
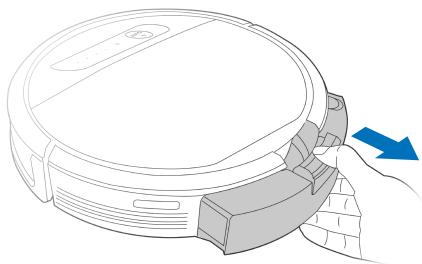

2

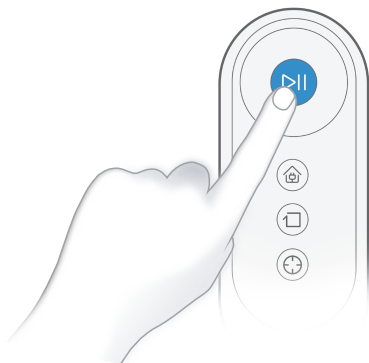

OR



ECOVACS App

1



Q ECOVACS



✓ iOS 9.0 or later ✓ Android 4.0 or later

2

2.4GHz
Wi-Fi

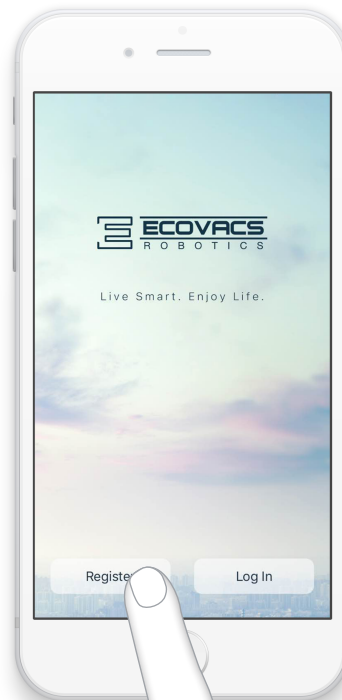

3

2.4GHz
Wi-Fi

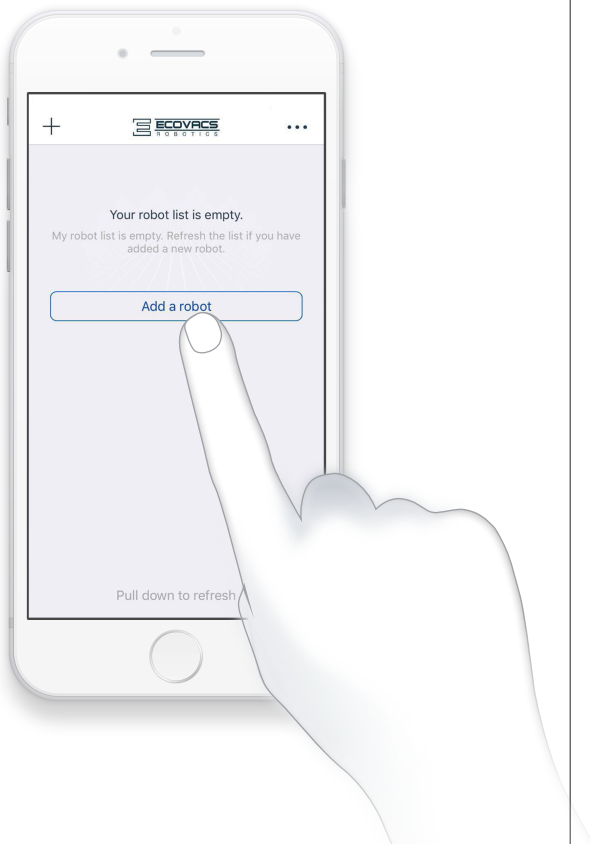

4

2.4GHz
Wi-Fi



Live Smart. Enjoy Life.

关门折 (8P)

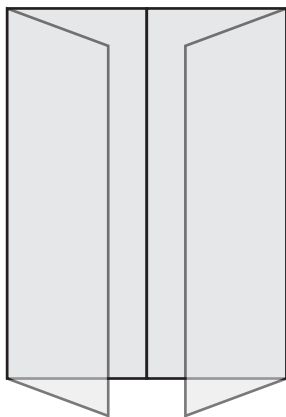

印刷页面顺序

正面

7	8	1	2
---	---	---	---

反面

3	4	5	6
---	---	---	---